



P-5 TW

Tunable White LED Wash Light



Description

The P-5 TW is a tunable white output version of the color P-5, which is the most well-known and reputed IP65 LED wash in the lighting industry. It is perfect for creating even coverage at a high light output. The P-5 TW uses 16bit dimming performance, it is completely upgradeable through firmware updates and it offers a full variety of beam angles for medium throws via interchangeable lenses.

Features and benefits

- | | |
|--|--|
| ✓ High-performance IP65 white LED light source | ✓ 43°, 21°, and 15° interchangeable lenses |
| ✓ 21958 lumens in W | ✓ DMX, RDM, and wireless control |
| ✓ 2200K - 5300K CTC control | ✓ Accurate 16bit dimming performance |
| ✓ Practically maintenance-free | ✓ Flicker-free / Programmable scenes |

Certifications & classifications

IP65

RoHS



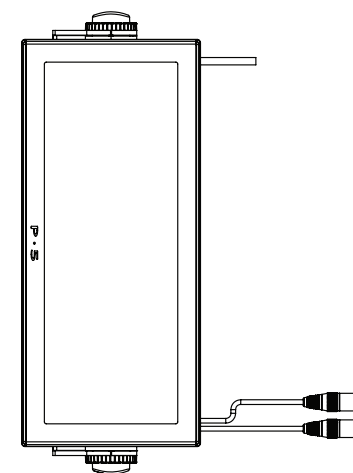
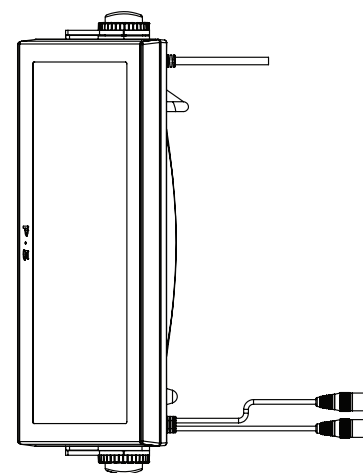
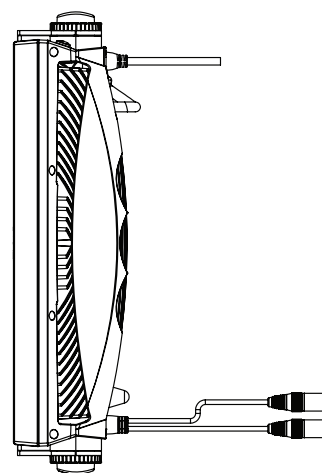
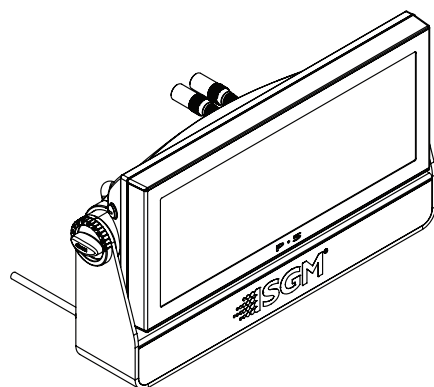
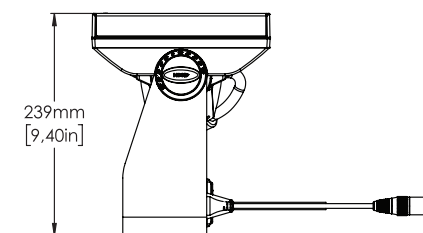
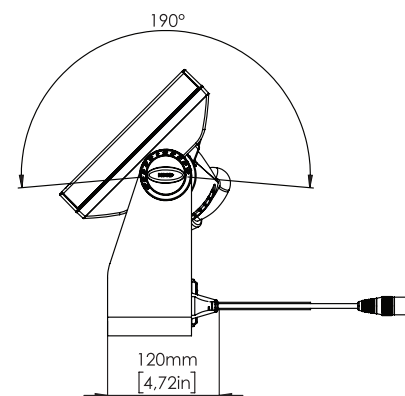
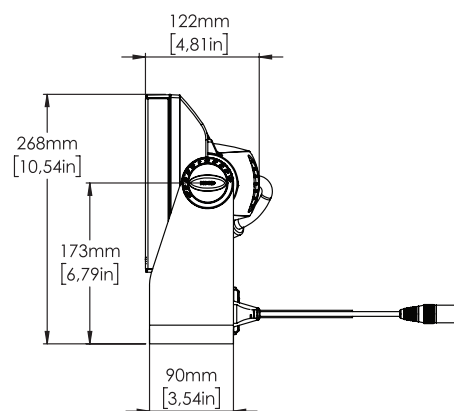
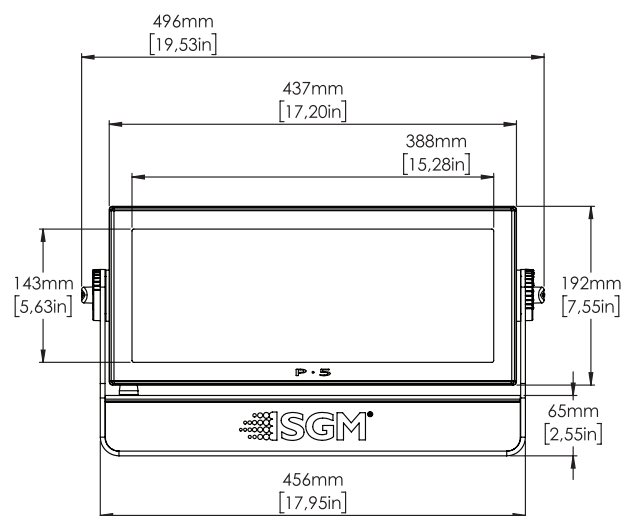

Specification

Optical Data	LED expected lifetime	50,000 hours
	Lightsource	44 x high-power 10W white LEDs (2,200K - 5,300K)
	Native lens options	15° 21° 43°
Photometric	Average CRI (CTC)	87
	Color temperature range	2200K - 5300K
	Efficacy	49 lm/W
	Light output all LEDs on	21958 lm
	Lumen per kilogram	2467 lm / Kg
	Lux @ 10m	1678 lux
	Lux @ 3m	3978 lux
	Lux @ 5m	6712 lux
	Max. CRI @ 3200K	84
	Native beam angle(s)	14° (with 15° lens) 26° (with 21° lens) 35° (with 43° lens)
	Native field angle(s)	79° (with 43° lens) 57° (with 21° lens) 34° (with 15° lens)
Physical	Color options	Black - RAL 9004 Custom color - Any RAL White - RAL 9010
	Effective Projected Area	1.72 Square ft
	IP class	IP65
	Lens material	PE
	Material	Aluminium
	Net dimensions	497 x 268 x 122 mm
	Net dimensions inches	19.6 x 10.6 x 4.8 inches
	Net weight	8.9 kg (19.6 lbs)
Features	Color calibration	Tunable white optimized for CTC
	Dimming	2 Smooth fade in, display selectable curves: gamma corrected, and linear
	Filters	Optional external spread angle filters (requires Accessory Holder)
	Other	LED frequency control, display selectable
	Strobe	Ultra-high-speed strobe effects

	Tilt	0 - 190°
Electrical	Electrical protection	Overload protection
	Input voltage, absolute max. rating	190 - 264 VAC; 50 / 60 Hz
	Input voltage, nominal	208 - 240 VAC; 50 / 60 Hz
	Max inrush current 230VAC	45 A
	Max power consumption	450 W
	Power factor	0.98 PF (230 V)
	Power Supply Unit	Auto-ranging electronic switch-mode
	Standby power consumption	8 W
Programming and Control	16-bit control	Dimmer
	Cabled DMX	5 pin XLR input/output
	DMX channels	2, 4, 6 or 8
	DMX modes	4
	Protocol	USITT DMX512A Wireless DMX (LumenRadio) RDM ANSI E1.20
	Setting and addressing	OLED graphical display / 4 buttons RDM ANSI E1.20 RFID Standalone mode
	Standalone mode	Quick Color Standalone mode programmable via RFID Up to 24 programmable scenes
	Wireless DMX	Lumen Radio with RDM
Connections	DMX data in/out	2 IP65 XLR 5-pin cables 0.5m (permanently wired)
	Power	Power cable 1 meter with bare ends (permanently wired)
Installation	Mounting point	2 x 2 quarter-turn locking points for one or two Omega brackets
	Orientation	Any
	Rigging possibilities	Floor stand (included) or hanging (Omega clamps included)
	Safety features	Bottom mount for safety wire Minimum distance to combustible materials: 0.3 meter (11 in).
Thermal	Cooling	Active, Forced Air, Temperature- regulated
	Humidity (max.)	98 %
	Temperature range, operating	-40°C to 50°C

	Temperature range, start-up	-20°C to 50°C
	Temperature range, storage	-40°C to 80°C
	Thermal protection	Automatic overtemperature protection
	Total heat dissipation, max power	1535.4 BTU per hour
	Total heat dissipation, standby	27.3 BTU per hour
Included items	Included items	Wireless DMX antenna Mounting bracket (incl. screws) 2 Omega bracket with quater-turn fasteners Safety instructions and installation quick guide
Conforms To	CE - 2014/30/EU: EMC Directive	EN 55103-1 EN 55103-2 EN 55015 EN 61547 EN 61000-3-2 EN 61000-3-3
	CE - 2014/35/EU: Low Voltage Directive	EN 60598-1 EN 60598-2-17 EN 62471 EN 60529
	RoHS2 Directive	2011/65/EU
	UL	UL Std. 1573
Certified To	CSA	CSA Std. C22.2 No. 166

NOTES:

Due to continuous improvements and innovations, specifications may change without notice.

LEDs' expected lifetime provided by manufacturer and obtained under manufacturer's test conditions.

Zoom range defined as a minimum beam angle to a maximum field angle.

Photometric measurements obtained with Goniometer Scan / SGM Illumination Lab 1.6.0.0.

Lumen output in pixel products is calculated.

Ordering information

Qty	Product name	Item number
<input type="checkbox"/>	P-5 TW Wash, 21deg, Std, BL	80030519
<input type="checkbox"/>	P-5 TW Wash, 15deg, Std, BL	80030522
<input type="checkbox"/>	P-5 TW Wash, 43deg, Std, BL	80030523
<input type="checkbox"/>	P-5 TW Wash, 43deg, Std, CU	80030559
<input type="checkbox"/>	P-5 TW Wash, 21deg, Std, CU	80030560
<input type="checkbox"/>	P-5 TW Wash, 15deg, Std, CU	80030548
<input type="checkbox"/>	P-5 TW Wash, 43deg, Std, WH	80030555
<input type="checkbox"/>	P-5 TW Wash, 21deg, Std, WH	80030557
<input type="checkbox"/>	P-5 TW Wash, 15deg, Std, WH	80030558
<input type="checkbox"/>		
	Accessories	Item number
<input type="checkbox"/>	P-5 Lens Kit, 15°	83061116
<input type="checkbox"/>	P-5 Lens Kit, 21°	83061117
<input type="checkbox"/>	P-5 Lens Kit, 43°	83061118
<input type="checkbox"/>	BCC-2 Dual Bracket	83060603
<input type="checkbox"/>	BCC-4 Quad Bracket	83060604
<input type="checkbox"/>	Omega Bracket with 1/4-turn fasteners	83060602
<input type="checkbox"/>	4-way Barndoors for P-5, i-5, X-5, Q-7	83061120
<input type="checkbox"/>	8-way Barndoors for P-5, i-5, X-5, Q-7	83061121
<input type="checkbox"/>	Accessory Holder for P-5 & i-5	83061119
<input type="checkbox"/>	Color Frame for P-5, Q-7, X-5, i-5	83061122
<input type="checkbox"/>	Floor Stand for P-5, X-5 & Q-7	83060610
<input type="checkbox"/>	Flight Case for 4 pcs of P-5/Q-7/X-5	82051501
<input type="checkbox"/>	Flight Case for 4 pcs of P-5/Q-7/X-5 incl. barndoors	82051502
<input type="checkbox"/>	SGM USB uploader cable	83062011
<input type="checkbox"/>	Vacuum Test Kit	83061136
<input type="checkbox"/>	A-4	80070217
<input type="checkbox"/>	Diffusion filter for P-5, i-5 - elliptical horizontal, external	83061027
<input type="checkbox"/>	Diffusion filter for P-5, i-5 - elliptical vertical, external	83061028
<input type="checkbox"/>	Diffusion filter for P-5, i-5 - medium, external	83061025
<input type="checkbox"/>	Diffusion filter for P-5, i-5 - wide, external	83061026
<input type="checkbox"/>	RDM Addressing Tool	
<input type="checkbox"/>		



Headquarter [+45 70 20 74 00](tel:+4570207400)

Mail info@sgmlight.com

Website sgmlight.com